

Molding Power Choke



Integrated forming inductor independent mold opening, with a number of design patents, a number of independent knowledge products; Small volume, small current, can maintain good temperature rise current and saturation current characteristics at high temperature; Adopt one body forming structure, strong, magnetic circuit closed, with good magnetic shielding and EMI performance; Magnetic shield structure, magnetic circuit closed, strong anti-electromagnetic interference, with very low buzzer, high installation density; Low loss alloy powder die-casting, low impedance; High precision, durable rust prevention;

Features

- Products are lead-free, in line with RoHS directive, Halogen Free and REACH Compliance
- SMD surface mount inductor
- The integrated structure avoids noise
- Lowest DC impedance of the same size
- The current resistance inductance value drops to ensure smooth
- Up to 5MHz application frequency
- Fully enclosed magnetic shielding structure can effectively reduce electromagnetic interference

Applications

- DC-DC converters
- Power modules
- CONSUME
- Laptop, MOTHERBOARD,INDUSTRY
- Communication networks, Internet of Things and other electronic devices

Product Identification

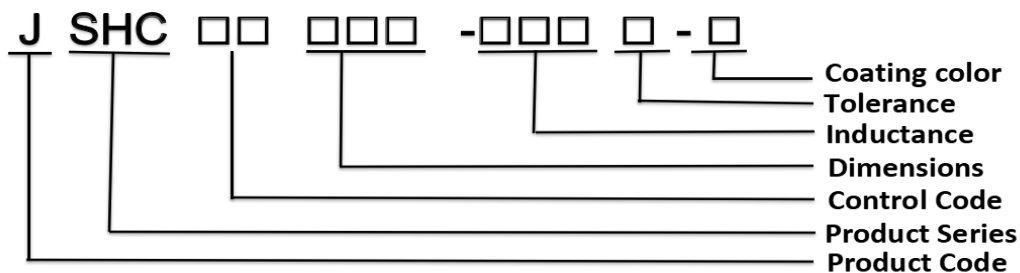

Appearance and dimensions

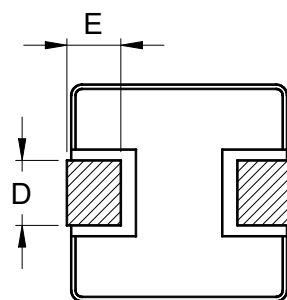
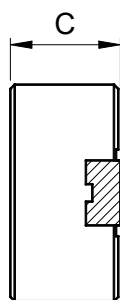
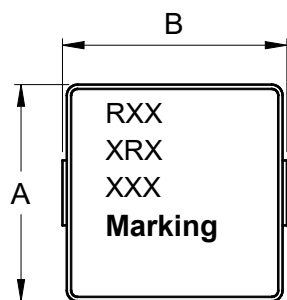

Schematic

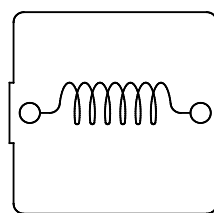

Reference PCB pattern

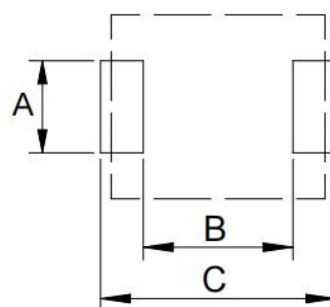

Dimensions in mm

Type	A	B	C	D	E
03xxH	3.3Max	3.9Max	2.0 Max	1.2±0.2	0.70±0.3
04xxH	4.5Max	4.9Max	2.0Max	1.5±0.5	1.0±0.3
05xxH	5.2Max	5.9Max	3.0 Max	2.0±0.3	1.2±0.3
06xxH	7.0Max	7.6Max	5.0 Max	3.0±0.3	1.5±0.5
08xxH	8.0Max	9.5Max	5.0 Max	3.0±0.3	2.0±0.5
10xxH	10.5Max	11.5Max	5.0Max	3.0±0.5	2.0±0.5
12xxH	12.5±0.3	13.5±0.3	3.5 Max	3.5±0.5	2.5±0.5
17xxH	17.15Max	17.8Max	7.0Max	11.8±0.3	3.3±0.5

mensions in mm

Type	A	B	C
03XXH	2.3ref	N/A	3.9ref
04XXH	2.5ref	1.8ref	4.8ref
05XXH	2.5ref	3.0ref	7.0ref
06XXH	3.5ref	3.7ref	8.4ref
08XXH	3.5ref	4.8ref	9.5ref
10XXH	4.8ref	5.0ref	12ref
12XXH	6.0ref	8.0ref	14.5ref
17XXH	12.8ref	11.2ref	18.7ref

Electrical Characteristics

Part Number	Inductance	Tolerance	Test Frequency	RDC	Isat	Irms
	(μH)	($\pm\%$)	(KHz)	($\text{m}\Omega$)Max	(mA) Max	(mA)Max
JSHC0420H-R10M-K	0.10	20	100	7.5	14.0	10.0
JSHC0420H-R22M-K	0.22	20	100	8	12.0	9.0
JSHC0420H-R33M-K	0.33	20	100	12	10.5	8.0
JSHC0420H-R47M-K	0.47	20	100	14	9.0	5.5
JSHC0420H-R56M-K	0.56	20	100	18	10.5	9.5
JSHC0420H-R68M-K	0.68	20	100	21	8.0	5.0
JSHC0420H-1R0M-K	1.0	20	100	27	6.3	4.1
JSHC0420H-1R5M-K	1.5	20	100	36	6.0	4.0
JSHC0420H-2R2M-K	2.2	20	100	58	5.0	3.0
JSHC0420H-3R3M-K	3.3	20	100	90	3.0	2.0
JSHC0420H-4R7M-K	4.7	20	100	150	3.0	2.0
JSHC0420H-5R6M-K	5.6	20	100	160	2.6	2.0
JSHC0420H-6R8M-K	6.8	20	100	170	2.5	2.0
JSHC0420H-100M-K	10.0	20	100	200	2.0	1.5
JSHC0420H-220M-K	22.0	20	100	480	0.8	0.6

Note: When ordering, please specify tolerance code. Tolerance: M= $\pm 20\%$

- All data is tested on 25°C ambient temperature.
- Inductance is tested at 100kHz, 1.0V.
- Heat rating current: The value of DC current when product temperature rise is $\Delta T 40^\circ\text{C}$ ($T_a=25^\circ\text{C}$).
- Saturation current: The value of DC current when the inductance decreases approximately 30% of its.

Special remind: Circuit design, component placement, frequency, cooling system and etc. all will affect the product temperature. Please verify the actual product temperature in the final application.

Heat rating current VS saturation current curv

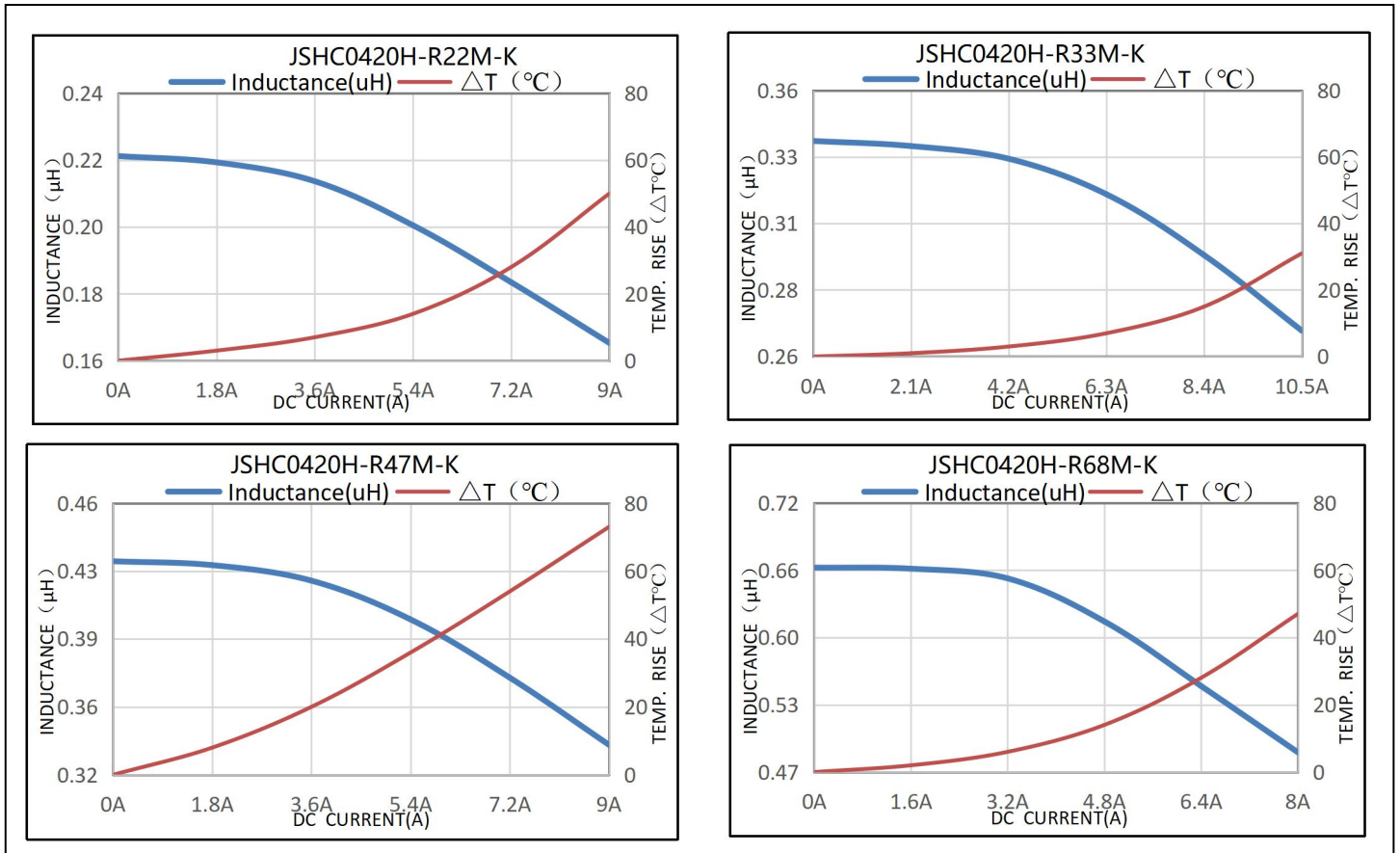

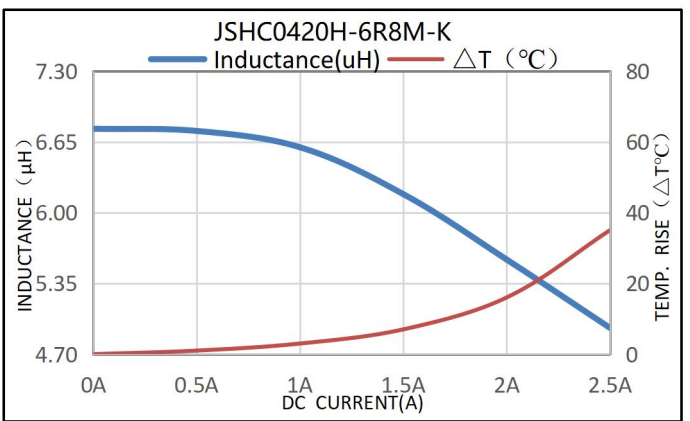
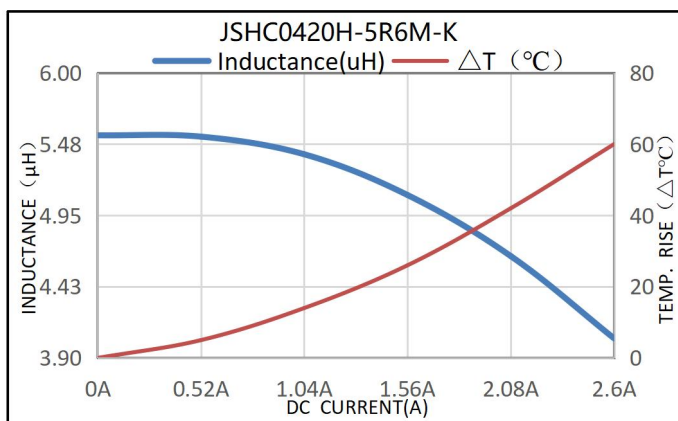
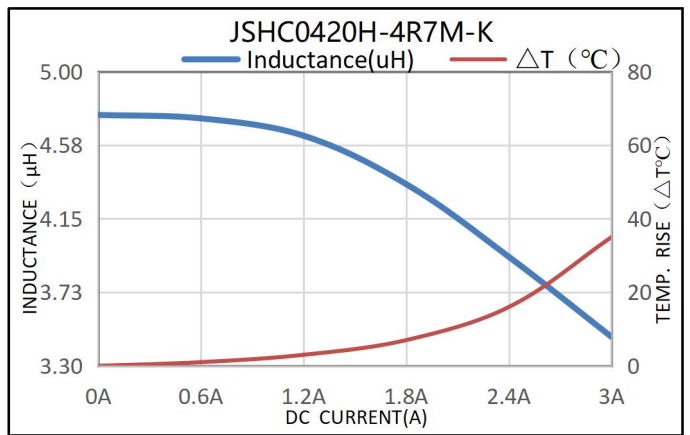
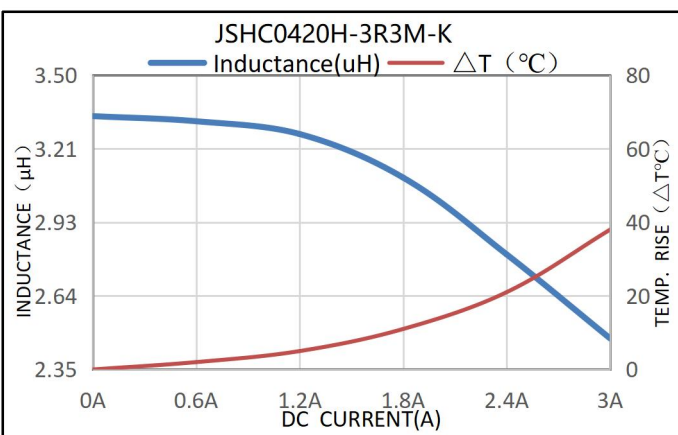
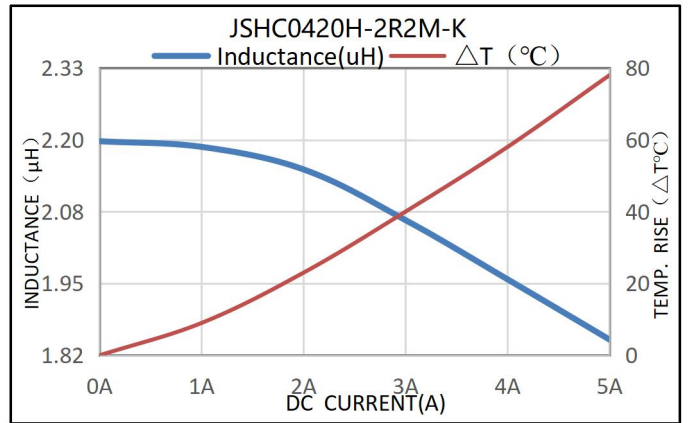
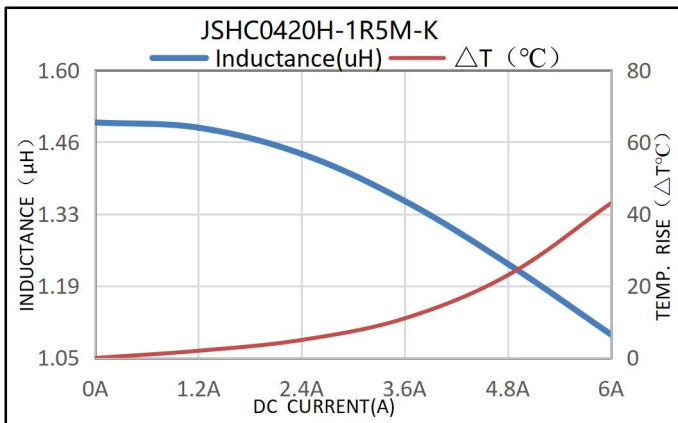
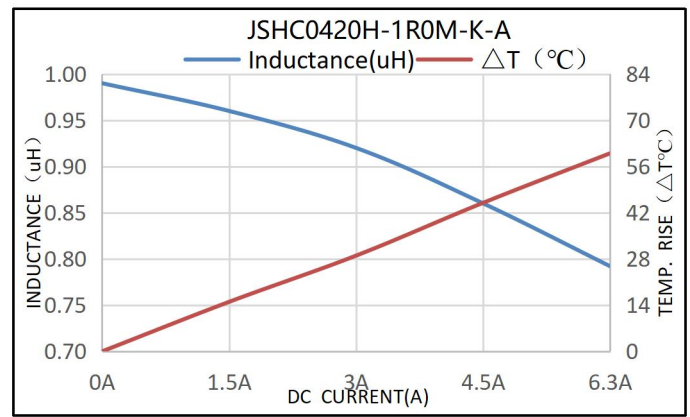
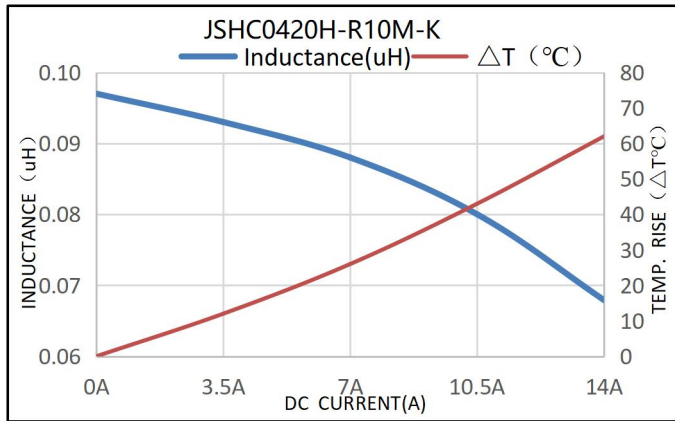

Packaging Specifications

Carrier tape dimensions

A0	4.35±0.2
B0	4.9±0.2
K0	2.25±0.1
W	12.0±0.3
P	8.0±0.2
F	5.50±0.1
T	0.35±0.05
D0	1.5±0.10

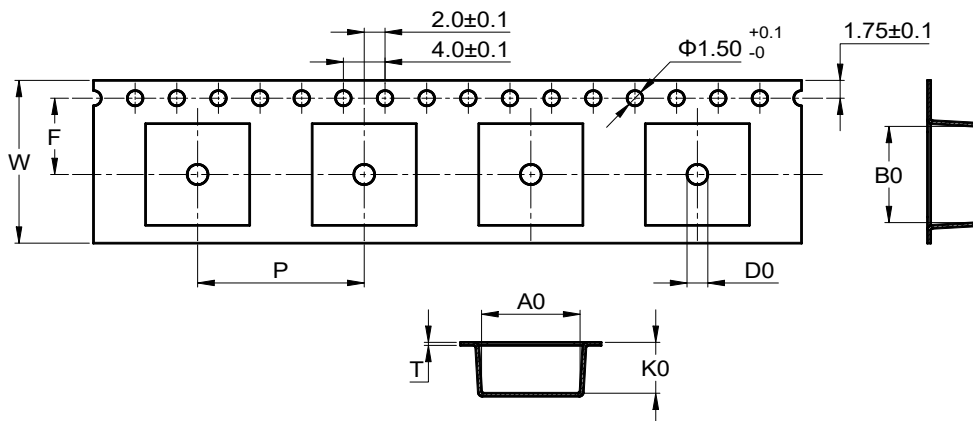

※ 包装参照国际标准 IEC 60286-3。

Packaging is referred to the international standard IEC 60286-3.

Packaging direction

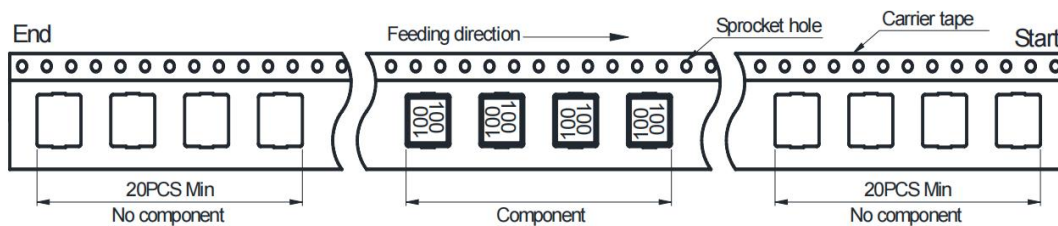

Reel Dimensions

A	330 ± 2.0
B	100 Min
C	20.0Max
D	12.5 Min

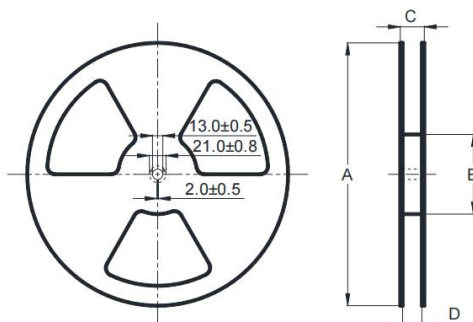

Dimensions in mm

TYPE	Tape Dimensions								Reel Dimensions				Quantity
	A0	B0	T	W	P	F	K0	D0	A	B	C	D	PCS / REEL
03xxH	3.45	4.0	0.35	12.0	8.0	5.3	2.20	1.5	330	100	20	12.5	3000
04xxH	4.35	4.9	0.35	12.0	8.0	5.5	2.25	1.5	330	100	20	12.5	3000
05xxH	5.40	5.3	0.30	12.0	8.0	5.5	2.20	1.5	330	100	20	12.5	2000
06xxH	7.40	7.95	0.35	16.0	12.0	7.5	3.30	1.5	330	100	20	16	1500
10xxH	10.60	12.0	0.40	24.0	16.0	11.5	4.30	1.5	330	100	28	24.5	750
12xxH	13.10	14.1	0.40	24.0	16.0	11.5	6.80	1.5	330	100	28	24.5	400
17xxH	17.55	19.20	0.50	32.0	24.0	14.20	7.70	1.5	330	100	36	32.5	300

Cover tape peel-off condition

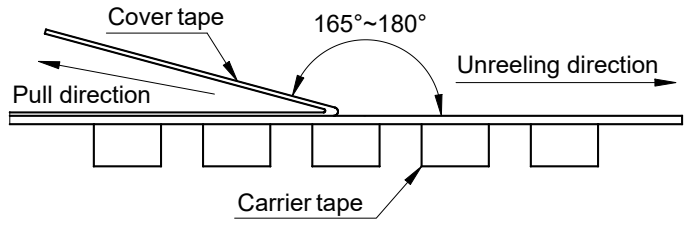
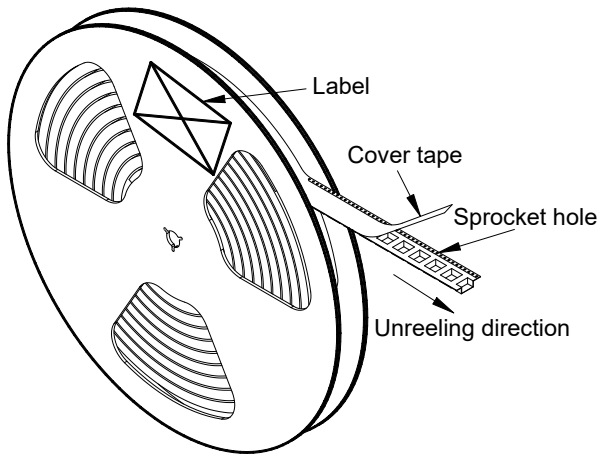

※ 盖带剥离力度为 0.1~1.3N.

Cover tape peel-off force will be 0.1 to 1.3N.

※ 参考剥离速度 300±10mm/分钟。

Reference peel-off speed 300±10mm/min.

Carton dimensions and packaging quantity

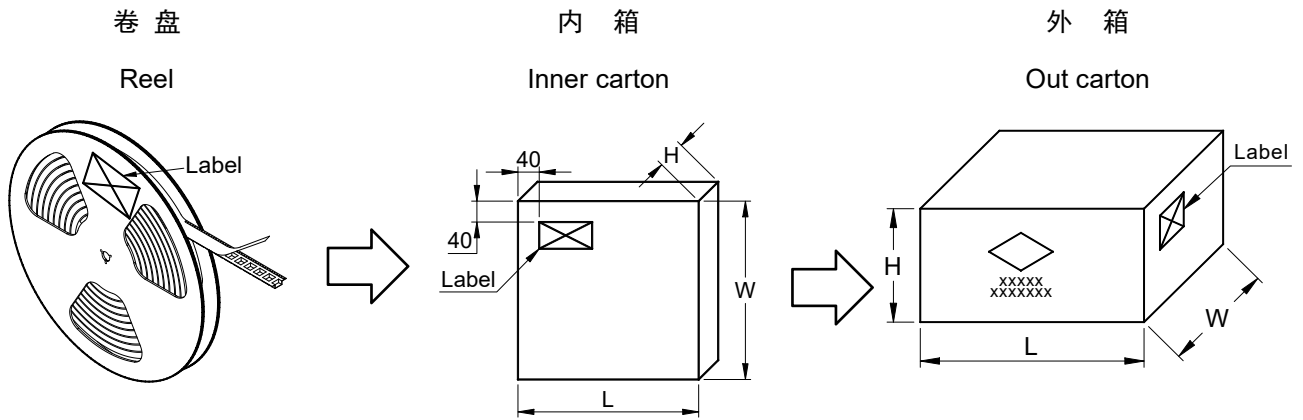

■ 内包装箱(L×W×H): 340×340×52mm

Inner Carton

■ 外包装箱(L×W×H): 354×354×176mm

Out Carton